

## GETTING *started*

### WITH YOUR MULTI-DOOR REFRIGERATOR



#### BEFORE YOU START



##### SET UP YOUR REFRIGERATOR

Remove tape and glue residue from surfaces before turning on the refrigerator. Choose a place near a grounded electrical outlet, allowing for clearances for ease of installation, proper circulation, and plumbing and electrical connections.



##### BEFORE OPERATING FOR THE FIRST TIME

Clean the inside of your appliance before using it. See **CARE AND CLEANING** in your Use & Care Manual. To ensure safe food storage, allow the appliance to operate with the door closed for at least 8 hours before loading it with food.

#### YOU'RE IN CONTROL



##### Appliance Control Display

For the first 24 hours, we recommend setting the temperature at 37°F (3°C) for the fresh food compartment and 0°F (-18°C) for the freezer. After 24 hours, you can adjust the temperature control as desired.

\*Control display varies by model.

#### EXTERNAL DISPENSER CONTROL DISPLAY

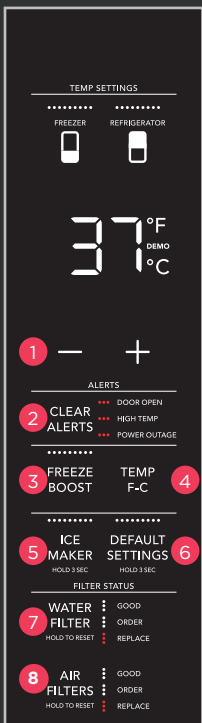

- CHANGE TEMPERATURE** Select Freezer or Refrigerator icon to change temperature. Press +/- buttons to set the temperature.  
Freezer control: -6°F/-21°C - range: +6°F/-15°C  
Refrigerator: +34°F/+1°C - control range: +44°F/+7°C
- CLEAR ALERTS** Resets any active lit door open, high temp or power outage alarms on the control display.
- FREEZE BOOST** Activate Freeze Boost prior to grocery shopping to lower the temperature and freeze food faster. Freeze Boost will remain active for up to 24 hours.
- F/C** Touch to toggle display from Fahrenheit to Celsius.
- ICE MAKER** Press and hold for 3 seconds to turn ice maker on/off. When indicator is lit, ice maker is on.
- DEFAULT SETTINGS** Press and hold for 3 seconds to reset to Factory settings.
- WATER FILTER** Press and hold to reset after filter has been replaced, status shown at right of button will reset to GOOD.
- AIR FILTERS**

#### INTERNAL DISPENSER CONTROL DISPLAY

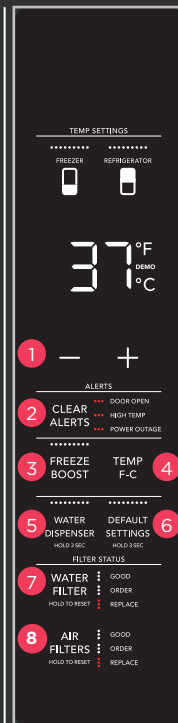

- CHANGE TEMPERATURE** Select Freezer or Refrigerator icon to change temperature. Press +/- buttons to set the temperature.  
Freezer control: -6°F/-21°C - range: +6°F/-15°C  
Refrigerator: +34°F/+1°C - control range: +44°F/+7°C
- CLEAR ALERTS** Resets any active lit door open, high temp or power outage alarms on the control display.
- FREEZE BOOST** Activate Freeze Boost prior to grocery shopping to lower the temperature and freeze food faster. Freeze Boost will remain active for up to 24 hours.
- F/C** Touch to toggle display from Fahrenheit to Celsius.
- WATER DISPENSER** When the water dispenser is turned on the LED's above Water Dispenser will illuminate.
- DEFAULT SETTINGS** Press and hold for 3 seconds to reset to Factory settings.
- WATER FILTER** Press and hold to reset after filter has been replaced, status shown at right of button will reset to GOOD.
- AIR FILTERS**

#### External Water Dispenser Controls

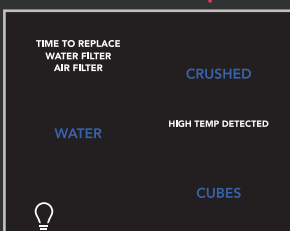

- WATER** Press "WATER" to select water.
- CRUSHED** Press "CRUSHED" to select crushed ice.
- CUBES** Press "CUBES" to select cubed ice.
- LIGHT** Toggles dispenser light on and off.



#### REMEMBER

See your Use & Care Manual for more detailed information about your appliance.

## KEEP IT FRESH



### Frigidaire PureAir® AF-2™ Replacement Refrigerator Air Filter

- More powerful than baking soda, the new **Frigidaire PureAir® AF-2™ Replacement Refrigerator Air Filter** absorbs undesirable smells keeping your fridge fresher for up to 6 months.
- The air filter is located at the top of the air tower. To change your filter:
  1. Place your fingers on top of air cover and gently pull toward you to release the top snaps of the cover from the air tower.
  2. Lift the bottom snaps up and out of the air tower assembly to disengage and remove the front cover and old filter.
  3. Press the new air filter into the snaps on the air filter cover. Reverse steps 1 and 2 to reinstall the air cover.
  4. Press and hold the Air Filters button after the filter has been replaced, and the filter status shown at the right of the button will reset to GOOD.

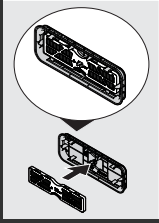

FRGPAAF2™

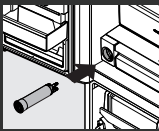

### Frigidaire PurePour® PWF-1™ Water & Ice Refrigerator Filter

- Makes safer water second nature - certified to reduce contaminants and keep great-tasting water flowing for you and your family for up to 6 months.
- The water filter compartment is located at the bottom left of the refrigerator compartment next to the Deli Drawer.
- Before dispensing water for the first time, be sure to prime the water supply system:
  1. Press and hold a drinking glass against the water dispenser paddle until water comes out (it may take up to 1½ minutes).
  2. Run water through dispenser for approximately 3 minutes or 1.5 gallons before use, and discard.



FPPWFU01™

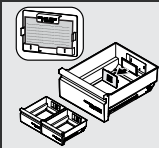

### Install your new PureAir® Produce Keeper™ PK-1 Refill to extend the life of produce (2 included)

1. Remove the outer plastic wrapper.
2. Insert the unopened packets into the holder in the Crisper Drawer.



FRPAPKRF™

## FAQs

### How do I use the internal water dispenser?

Your internal water dispenser is mounted on the left hand refrigerator door. To use the dispenser simply place your cup under the nozzle and push the paddle to dispense water.

### Why does my refrigerator run most of the time? Is this normal?

Today's refrigerators are designed to be more energy efficient than previous models. This means they run longer cycles, or run continuously, to maintain an even temperature inside. Please note: starting a unit takes about 10 times as much energy as it does to keep it running.

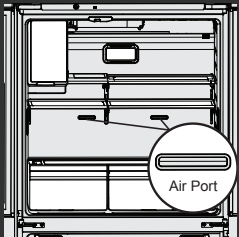
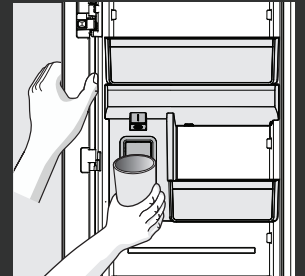

### The temperature is warmer or colder than preferred. What can I do?

Simply adjust the temperature by 1 or 2 degrees and allow 24 hours for the temperature to stabilize. Check to ensure food items are not blocking the multi-port air exhaust ducts as this will impact temperature performance. **Find more troubleshooting tips in the back of your Use & Care Manual.**

### Why is food freezing in my refrigerator?

Food placed within 1 inch in front of the air ports may cause food to freeze. See **Controls and Settings** in your Use & Care Manual.

## LET'S MAKE IT OFFICIAL!

Take the first step to becoming a part of the Frigidaire family and discover more benefits by registering your multi-door refrigerator.

Look for the Photoregister<sup>SM</sup> icon on your registration card.

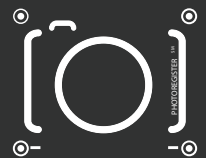

WE ARE  
*here*  
FOR YOU



Have a question?



Want help?



Need service?

owner support

frigidaire.com 1 (800) 374-4432

frigidaire.ca 1 (800) 265-8352

