



SCAN FOR
MORE INFORMATION

DRIJA

1 YEAR
WARRANTY

STEAMER/AIR FRYER PORCHETTA

4.5L
AIR FRYER



7.5L
STEAMER



**TEMPERED
GLASS**



RANGE HOODS



COOKTOPS



MICROWAVES



OVENS



WINE COOLERS



REFRIGERATORS



WATER
HEATERS

USER MANUAL

120V / 60Hz

NOTE: To purchase accessories and / or spare parts for this product, contact us at the Contact Center (depending on the number of your country that indicates the warranty certificate or our social media)

www.drijainternational.com

IMPORTANT SAFETY INSTRUCTIONS

- Please read these rules carefully before operating the airfryer. Failure to comply with these rules will void all warranty conditions.
- Please use an independent socket, do not share the socket with other electrical appliances.
- If it is used on an uninsulated table, please place a heat insulation pad under the product.
- This product is only for home use.
- For the first time use or when the glass pot is cooled down, you can preheat it for better effect.
- Do not touch the glass pot when cooking.
- Food must be placed on the rack and not block the air duct.
- When cooking, do not add water or other non-ventilated, non-heat-resistant utensils (such as plastic) to the glass pot, so as not to affect the cooking effect.
- After use, please unplug the power plug immediately.
- Please unplug the power plug and wait for the product to cool completely before cleaning.
- Do not flush the machine directly with water. You can wipe the stain with a soft towel. Please do not wipe this product with alcohol or volatile substances.
- When cleaning or cooking, please avoid bumping the glass pot to avoid damage.
- When the product is operating, the distance between the product and the wall needs to be greater than 10cm.
- If you find that there is abnormal noise or large vibration after the product is powered on, please cut off the power first, and then contact the supplier for inspection and maintenance.
- Do not use a damaged power supply or power plug to avoid electric shock and fire.
- This product is not intended for use by children, persons with disabilities, mental disabilities, and lack of relevant experience and knowledge, unless someone has instructed and supervised them how to use this product safely.
- If the power cord is damaged, it must be replaced by professionals such as the manufacturer and its maintenance department.

PARAMETER

PRODUCT NAME	MODEL	RATED VOLTAGE	RATED FREQUENCY	RATED POWER
2 IN 1 AIR FRYER	PORCHETTA	110V	60HZ	STEAMER: 800W AIR FRYER: 1200W

PRODUCT OVERVIEW

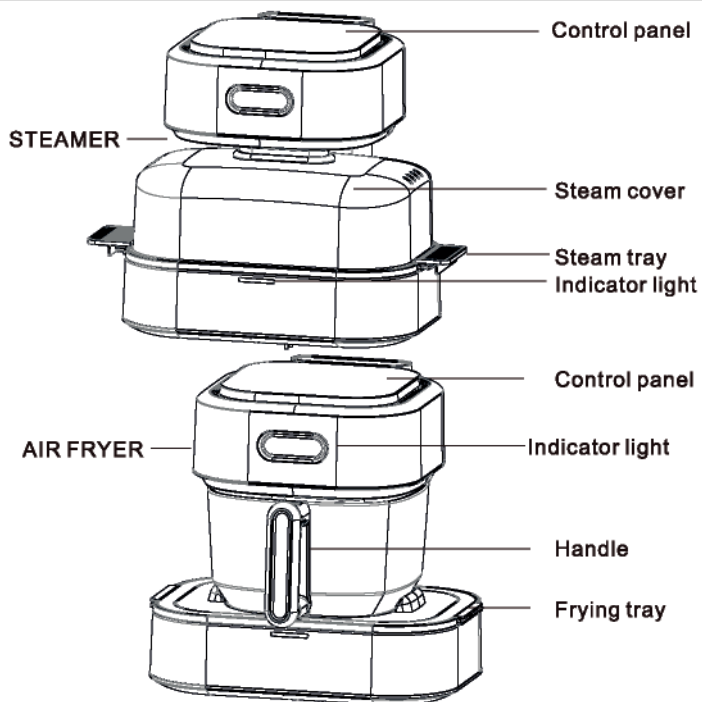

! KIND TIPS

The supplier has the right to change the design of the product. The product you purchased may be improved, and it is not completely with the manual. It will not change the performance and usage of the product. Please use it with confidence.

CONTROL PANEL

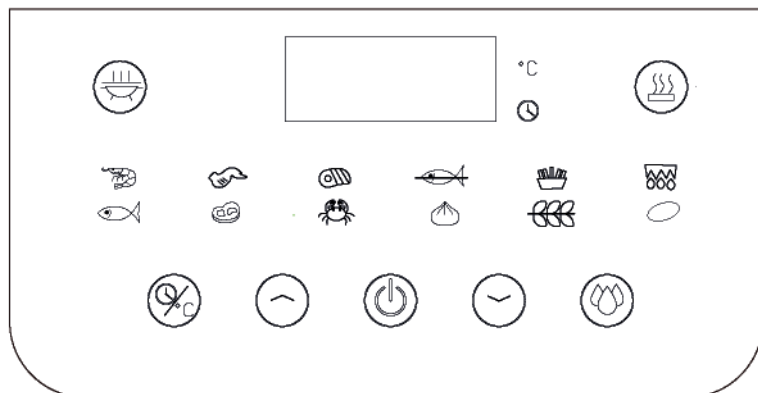

INSTRUCTION

• Operation of Air Fryer

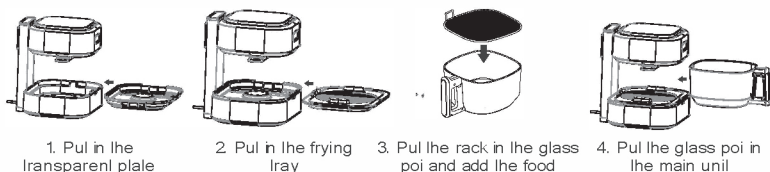

- Turn on the power, all the icons on the panel light up once, and the power icon flashes
- Press the button "@" and then press the "@" button to select the program, if there is no operation for three seconds, the air fryer will automatically operate; or you can press the button "@" again after the program is selected, the air fryer will start operating immediately. The display alternately shows the default cooking time and temperature.
- Unfreeze function: Put the thawed food into the glass pot first, then turn on the power. Press the button "@", and then press the button "@" to select the program.
- Automatic humidification function: After the program is selected, press the "@" button, and then press the "@" button, the air fryer will turn on the automatic humidification function;
- Manual humidification function: During the operation of the air fryer, press the "@" button according to the state of the food, and the air fryer will automatically humidify for three seconds

- NOTE:
- The product has the function of automatically identifying the water level, please fill the chassis with water before use (Do not exceed the water level line):
 - You can set the cooking time and temperature by yourself according to the different food
 - When the function is normal, the indicator light will be on constantly
 - The product has the shake function to remind user to turn over the food

• Operation of Steamer

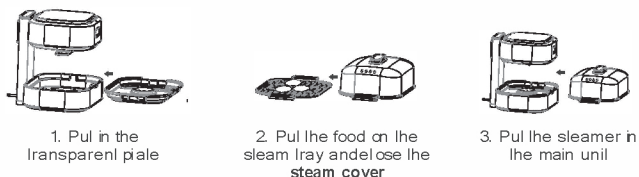

- Turn on the power, all the icons on the panel light up once, and the power icon flashes
- Press the button "@" and then press the button "®" to select the program, if there is no operation for three seconds, the steamer will automatically operate; or you can press the button "@" again after the program is selected, the steamer will start operating immediately. The display alternately shows the default cooking time and temperature.

- NOTE:
- The product has the function of automatically identifying the water level, please fill the chassis with water before use (Do not exceed the water level line):
 - You can set the cooking time and temperature by yourself according to the different food
 - When the function is normal, the indicator light will be on constantly
 - The product has the shake function to remind user to turn over the food

INSTRUCTIONS

AIR FRYER

Program/Temperature/Timer		
Program	Default Temperature	Temperature Setting Range
Shrimp	200°C	60°C-200°C
Chicken Wing	180°C	60°C-200°C
Steak	200°C	60°C-200°C
Ribs	190°C	60°C-200°C
Fish	180°C	60°C-200°C
Fries	190°C	60°C-200°C

STEAMER

Program/Temperature/Timer		
Program	Default Timer	Timer Setting Range
Fish	10 mins	1-60mins
Bun	20 mins	1-60mins
Crab	30 mins	1-60mins
Egg	30 mins	1-60mins
Shellfish	20 mins	1-60mins
Corn	25 mins	1-60mins

KIND TIPS

1. Please wait until the glass pot cools down before cleaning
2. The product exhaust vent should not be close to the wall
3. Be carefully with the exhaust vents and the steam discharged to avoid burn

CLEANING AND MAINTANCE

1. Please unplug the power supply and wait for the product to cool down completely before cleaning
2. The glass pot and rack can be washed in the dishwasher
3. Please avoid hitting the glass pot when cleaning
4. After cleaning, wipe the shell, glass pot and rack with dry cloth

FAILURE ANALYSIS

Failure	Solution
There is smoke or peculiar smell when using the machine for the first time	When use for the first time , bake for 5 mins without food, so as to completely evaporate the protective grease of the parts
The machine does not work	Check whether the plug is properly inserted into the socket or the glass pot is placed correctly
The machine does not heat	Check whether the plug is properly inserted into the socket or the glass pot is placed correctly
Glass pot is broken	Please contact the after-sales service

● If you still have problems in use , please contact the after-sales service